



## MILVACO TRUCK TANK FAUCETS WITH "PERMADISC" CONSTRUCTION

The "MILVACO" Truck Tank Faucet, with "Permadiisc" Construction is faster and engineered to provide uninterrupted service for a long period of time.

"Permadiisc" is an exclusive "MILVACO" development. The encased disc is held rigidly confined within the discholder, entirely eliminating the possibility of disc distortion, and is reversible as well as renewable should this become necessary.

"MILVACO" Truck Tank Faucets have met with high approval of the Oil Industry as shown by the many thousands in use. Designed for long, uninterrupted service under the most severe conditions for which it is recommended.



No. P-851  
Truck Tank Faucet  
with Locking Type  
Safety Cap, less  
Handle

FURNISHED OF BRONZE, UNLESS MILVALLOY IS SPECIFIED.

FOR MILVALLOY TRUCK TANK FAUCETS USE  
AFFIX "M" AFTER FIGURE NUMBER.

Description	Sizes
No. P-849, Faucet, only.....	1½" 2"
No. P-851, Faucet, with Safety Cap, less Handle.....	1½" 2"
No. P-859, Faucet with Standard Adaptor No. P-2944 for Quick Hose Connection, less Handle.....	1½" 2"

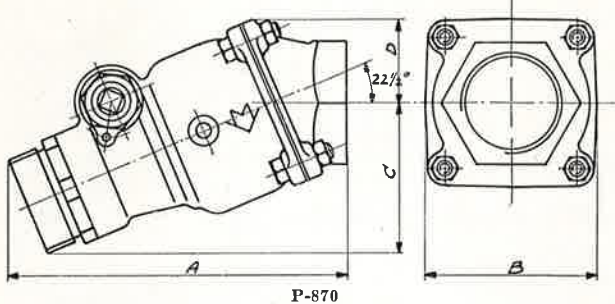

P-870

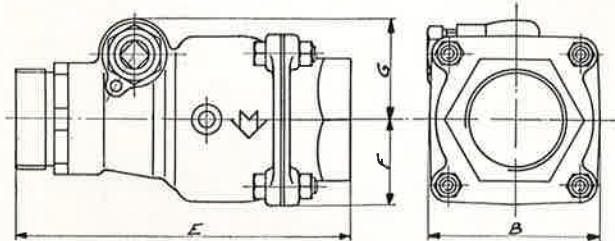

P-875

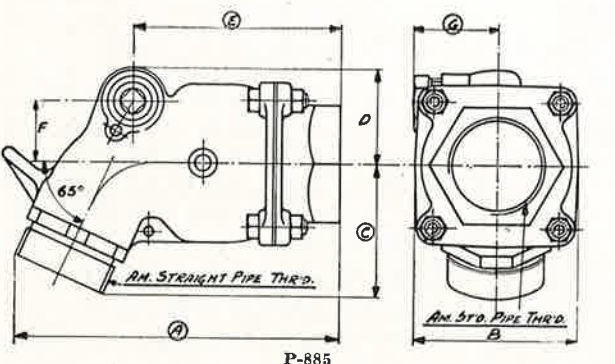

P-885

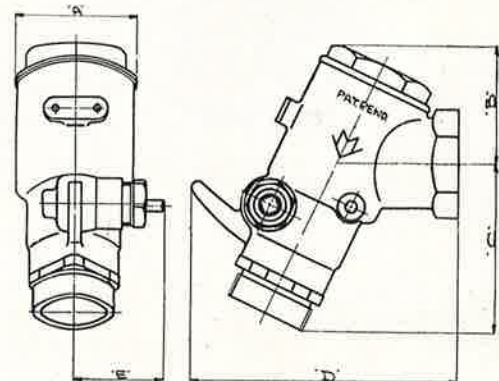

ROUGHING-IN DIMENSIONS FOR NO. P-849

Size	A	B	C	D	E
1½"	2 7/8"	2 3/4"	4 3/8"	6 13/16"	2 3/8"
2"	3 1/2"	3 1/16"	4 7/8"	7 3/4"	2 9/16"

ROUGHING-IN DIMENSIONS FOR NOS. P-870, P-875

Size	A	B	C	D	E	F	G
2"	8"	4"	3 7/16"	2"	7 7/8"	2"	2 3/8"
2½"	9 3/8"	5 3/8"	4 1/4"	2 3/4"	9 1/4"	3"	2 3/8"
3"	10 1/8"	6 3/8"	4 1/2"	3 3/8"	9 9/8"	3 5/8"	2 7/8"

ROUGHING-IN DIMENSIONS FOR NOS. P-885

Size	A	B	C	D	E	F	G
2"	8"	4"	3 1/4"	2 3/8"	5 1/8"	1 1/2"	2 1/8"
2½"	9 3/4"	5 3/8"	4"	2 5/8"	6"	1 3/4"	2 3/8"
3"	10 3/4"	6 3/8"	4 3/8"	2 7/8"	6 1/4"	2"	2 5/8"